

# S-LF3-CR

## OPERATING GUIDE SPEAKER SYSTEM

### CONTENTS

This system is comprised of 1 Center and 2 Rear speakers

#### **IMPORTANT NOTICE:**

The serial number for this equipment is located on the rear. Please write this serial number on your warranty and keep it in a secure area for future reference.

### BEFORE USE

- Thank you for buying this Pioneer product.
- Please read through this operating guide before using your speaker system so you will know how to optimize performance. After you have finished reading the operating guide, store it in a safe place for future reference.
- The rated impedance of this speaker system is  $8 \Omega$ . It must be connected to an amplifier which accepts this type of load (minimum and maximum impedances accepted by the amplifier are generally indicated near the loudspeaker outlets: for example "4-16  $\Omega$ " or "6-16  $\Omega$ ").
- To guard against damage to this speaker system due to an electric power overload, take the following precautions:
  - Do not supply power to the speaker system in excess of the maximum permissible input.
  - When connecting or disconnecting cables, be sure the amplifier power is OFF.
  - When using a graphic equalizer, do not use excessive amplifier volume.
  - Do not try to force a low-powered amplifier to produce loud sound (the amplifier's distortion will be increased, and you may damage the tweeter).
  - Avoid touching the diaphragms and suspensions of the speaker units as they are fragile.

#### **NOTE:**

The speaker units in this speaker system are magnetically shielded. However, colours may blur if the speakers are positioned too close to a television screen. If this happens, switch off the television and switch it back on again after 15 to 30 minutes. If the problem persists, move the speakers away from the television set.

### INSTALLATION PRECAUTIONS

- The S-LF3-CR system is composed of 1 center speaker and 2 rear speakers.
- For optimum effect, install the rear speakers above ear level.
- Install the centre speaker above or below the TV so that the sound of the center channel is localized at the TV screen.
- Do not install these speakers close to an oven or heating appliance. Avoid exposing them to direct sunlight. High temperature can distort the structure of the enclosure and adversely affect the sound.
- These speakers are heavy and fragile, therefore it is dangerous to install them in an unstable position.

## CONNECTIONS

- Switch off the amplifier power supply (OFF).
- Connect the speaker wires to the input terminals at the rear of the speaker; connect the common-side wire to the  $\ominus$  terminal and the hot-side wire to the  $\oplus$  terminal. Bear in mind that the red input terminal has a " $\oplus$ " polarity, and the black terminal has a " $\ominus$ " polarity.
- Connect the wire to the loudspeaker outlet terminals of the amplifier. Connect the hot-side wire to the  $\oplus$  terminal and the common-side wire to the  $\ominus$  terminal.

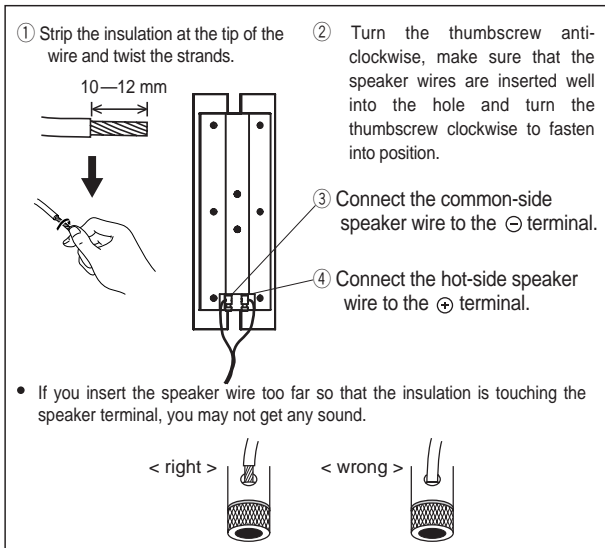

### REMARKS:

- Check that the wires are securely connected to the terminals. A loose connection may cause not just intermittent or distorted sound but short-circuiting and breakdown of the amplifier.
- If there is too much exposed wire outside the terminal, speaker wires may touch causing the amplifier to short, damaging the amplifier and making it unusable.
- If the wires of one of the speakers have been connected with the wrong polarities, you will find when listening to a stereo recording that bass sounds are weakened and the stereo effect normally obtained between the two speakers does not exist.

### CAUTION:

The speakers are equipped with a protection device to protect the transducers from extreme conditions. Under these conditions the protection device will activate and stop the speaker from producing sound. If this happens shut off the system for 5-10 minutes and allow the protection device to reset.

## USING THE ACCESSORIES

Confirm that the following accessories are in the box when you open it:

- Speaker stands + 1 polybag including 6 screws

### Center speaker:

This speaker stand 1 will enable you to set the centre speaker horizontally on a flat surface. The 2 screws that hold the speaker stand must be fixed into the dedicated insert in the speaker system.

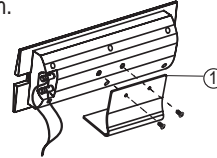

### Rear Speaker:

Before screwing the speaker stand 2 to the back of the cabinet, thread the speaker wires through the opening in the speaker stand and then connect them to the input terminal. The 2 screws that hold the speaker stand must be screwed into the dedicated inserts in the speaker.

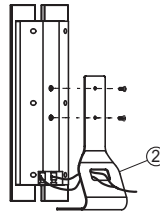

- 3 Mounting panels

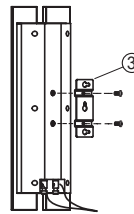

This Mounting panel 3 will enable you to set the speaker system on your interior's walls. Before screwing the mounting panel, make sure that wires are properly connected to the input terminal. The 2 screws that hold the mounting panel must be fixed into the dedicated inserts in the speaker system.

### Caution

In order to prevent the speaker from falling make sure the wall is sturdy enough to support the weight of the speaker. Do not mount it on plywood boards or soft-surface walls. Mount the speaker system on a flat wall, this will reduce the pressure on the screws, avoiding the risk of become loose, and preventing the speaker system from falling. If you are unsure of the quality and strength of the wall, consults a professional for advice.

- 1 Operating instruction/Warranty

### NOTES:

- Pioneer will not be responsible for any accidents or damages resulting from improper installation.

## CABINET MAINTENANCE

- Use a cloth to wipe away dust and dirt.
- If the enclosure is very dirty, wipe with a soft cloth dipped in a neutral detergent diluted five to six times with water, then wipe again with the dry cloth.
- Do not use thinner, benzene, cleaning sprays or other chemical products on or near the enclosures as the surfaces could be adversely affected.



**LIMITED WARRANTY**

PIONEER ELECTRONICS (USA) INC.

PIONEER ELECTRONICS OF CANADA, INC.

**WARRANTY PERIOD**

For the period specified below from date of original retail purchase (the warranty period) from an authorized Pioneer dealer, Pioneer Electronics (USA) Inc. (PUSA), and Pioneer Electronics of Canada, Inc. (POC) warrants that products distributed by PUSA in the U.S.A., and by POC in Canada that fail to function properly under normal use due to a manufacturing defect when installed and operated according to the operating instructions enclosed with the unit will be repaired or replaced with a unit of comparable value, at the option of PUSA or POC, without charge to you for parts or actual repair work. Parts supplied under this warranty may be new or rebuilt at the option of PUSA or POC.

PRODUCT	WARRANTY PERIOD	
	PARTS	LABOR
Loudspeakers / Subwoofers (amplifier section not included) .....	1 YEAR	1 YEAR
Amplifier Section (if applicable) .....	1 YEAR	1 YEAR

This warranty covers the product during the warranty period whether in the possession of the original owner or any subsequent owner. In the event service is required, the product must be delivered within the warranty period, transportation prepaid, from within the Country of purchase as explained in this document. You will be responsible for removal and installation of the product.

**WHAT'S NOT COVERED**

This warranty does not cover any product which is used in any trade or business, or in an industrial or commercial application. This warranty does not apply to any speaker that has been subjected to power in excess of its published power rating. This warranty does not cover the cabinet or any appearance item, any damage to the product resulting from alterations or modifications not authorized in writing by PUSA or POC, accident, misuse or abuse, or damage due to lightning or to power surges. This warranty does not cover the cost of parts or labor which would be otherwise provided without charge under this warranty obtained from any source other than a PUSA OR POC Authorized Service Company or other designated location. This warranty does not cover defects or damage caused by the use of unauthorized parts or labor, or from improper maintenance. **ALTERED, DEFACED OR REMOVED SERIAL NUMBERS VOID THIS WARRANTY.**

**YOUR RIGHTS**

PUSA and POC excludes any obligation on its part for incidental or consequential damages related to the failure of products to function properly under the conditions set forth above. IN THE U.S.A. - PUSA LIMITS ITS OBLIGATIONS UNDER ANY IMPLIED WARRANTIES INCLUDING, BUT NOT LIMITED TO, THE IMPLIED WARRANTIES OF MERCHANTABILITY AND FITNESS FOR A PARTICULAR PURPOSE, TO A PERIOD NOT TO EXCEED THE WARRANTY PERIOD. NO WARRANTIES SHALL APPLY AFTER THE WARRANTY PERIOD. SOME STATES DO NOT ALLOW LIMITATIONS ON HOW LONG AN IMPLIED WARRANTY LASTS, AND SOME STATES DO NOT ALLOW THE EXCLUSION OR LIMITATION OF INCIDENTAL OR CONSEQUENTIAL DAMAGES, SO THE ABOVE LIMITATIONS OR EXCLUSIONS MAY NOT APPLY TO YOU. THIS WARRANTY GIVES YOU SPECIFIC LEGAL RIGHTS, AND YOU MAY HAVE OTHER RIGHTS WHICH MAY VARY FROM STATE TO STATE. IN CANADA - EXCEPT AS EXPRESSLY PROVIDED HEREIN, THERE ARE NO REPRESENTATIONS, WARRANTIES, OBLIGATIONS OR CONDITIONS, IMPLIED, STATUTORY OR OTHERWISE, APPLICABLE TO THIS PRODUCT.

**TO OBTAIN SERVICE**

PUSA and POC have appointed a number of Authorized Service Companies throughout the U.S.A., and Canada should your product ever require service. To receive warranty service you will need to present your sales receipt or, if rented, your rental contract showing place and date of original owner's transaction. Should it become necessary to ship your unit, you will need to package the product carefully and send it, transportation prepaid by a traceable, pre-insured method, to an Authorized Service Company. Carefully package the product using adequate padding material to prevent damage in transit. The original container is ideal for this purpose. Include in the package your name, address, telephone number where you can be reached during business hours, a copy of your sales receipt and a detailed description of the problem. PUSA or POC, as appropriate, will pay for the cost of returning the repaired or replacement product to you within the Country of purchase.

For additional information about this limited warranty or to locate the nearest PUSA or POC Authorized Service Company, please contact:

**IN THE U.S.A.**  
CUSTOMER SERVICE DEPARTMENT  
PIONEER ELECTRONICS (USA) INC.  
P.O. BOX 1760  
LONG BEACH, CA 90801 USA  
Phone: 1-800-421-1404

**IN CANADA**  
CUSTOMER SERVICE DEPARTMENT  
PIONEER ELECTRONICS OF CANADA, INC.  
300 ALLSTATE PARKWAY  
MARKHAM, ON L3R 0P2  
Phone: 905-479-4411, 1-877-283-5901

**DO NOT RETURN ANY PRODUCT TO THE ABOVE ADDRESSES. THEY ARE NOT SERVICE LOCATIONS.**

**RECORD THE PLACE AND DATE OF PURCHASE FOR FUTURE REFERENCE**

Model No.: \_\_\_\_\_ Serial No.: \_\_\_\_\_  
Purchase Date: \_\_\_\_\_ Purchased From: \_\_\_\_\_

KEEP THIS INFORMATION AND YOUR SALES RECEIPT IN A SAFE PLACE

**PIONEER CORPORATION** 4-1, Meguro 1-Chome, Meguro-ku, Tokyo 153-8654. Japan  
PIONEER ELECTRONICS (USA) INC. P.O. BOX 1540, Long Beach, California 90801-1540  
PIONEER ELECTRONICS OF CANADA, INC. 300 Allstate Parkway Markham, Ontario L3R 0P2, Canada  
PIONEER ELECTRONIC (EUROPE) N.V. Haven 1087 Keetberglaan 1,9120 Melsele, Belgium, TEL: 03/570.05.11  
PIONEER ELECTRONICS AUSTRALIA PTY. LTD. 178-184 Boundary Road, Braeside, Victoria 3195, Australia, TEL: [03] 9586-6300  
PIONEER ELECTRONICS DE MEXICO S.A. DE C.V. San Lorenzo Num 1009 3er piso Desp. 302 Col. Del Valle, Mexico D.F. C.P. 03100 TEL: 5-688-52-90

Printed in China <284317-A>

Published by Pioneer Corporation.  
Copyright © 2004 Pioneer Corporation.  
All rights reserved.