

STEP4 Check the System Version

- ① Press the STANDBY/ON button to start up the unit.
- ② Press the FUNCTION button on the front panel to display the [Function Menu] then select [SYSTEM] in SET UP.
- ③ Select [Information] to verify that the [System Version] is updated.

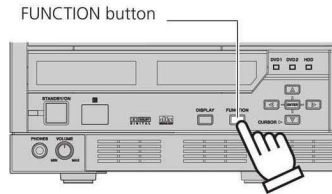

Function Menu Display



System Version Check Display

TROUBLESHOOTING

You started the update mode without loading the disc.



Turn the unit OFF then ON again.

The update mode failed to start up and the unit entered the ordinary power ON mode.



You might released the ENTER button too early. Press the STANDBY/ON button to put the unit in the standby mode, and then restart the installation by following the updating procedure.

You turned off the unit accidentally in the middle of updating.



Restart the installation by following the updating procedure. If the unit will not start up normally, please contact our Technical Support Center.

PRV-LX1 SYSTEM UPDATE GUIDE



Thank you for purchasing the PRV-LX1 DVD recorder.

This PRV-LX1 System Updating Guide is shipping with the update program on CD-ROM.

Please update your PRV-LX1 by following the procedure described in this document.

For questions about this system update, please contact our Technical Support Center.

Technical Support Center **(800) 421 - 1613**

Email: LX1-help@pioneer-usa.com

Executing this update DOES NOT DELETE your imported menu background graphics, EDLs, image files, or Video files recorded to the HDD. However, DOWNGRADING the system will cause all user files to be lost.

Before Updating

Please read these instructions thoroughly before starting the update process.

Guard against unexpected power failures during a system update as the unit may become unable to start normally after it has been powered OFF in the middle of an update.

Should the unit fail to start normally due to an unexpected power failure, try upgrading the system again as described in this document. If the unit still fails to start normally, please contact the Pioneer Technical Support Center.

UPDATE PROCEDURE

STEP 1 Preparation for Updating

Verify that the unit is OFF before proceeding.

* With the unit in Standby mode, turn OFF the main power switch located on the back panel.

* The unit is OFF when the Power indicator on the front panel is extinguished.

- ① Connect the video output of the unit to the video input of the monitor so that the monitor can display the played video.
- ② Plug the unit's power cord in to a wall outlet.
- ③ Prepare the Update Disc.

Front Panel Power Indicator

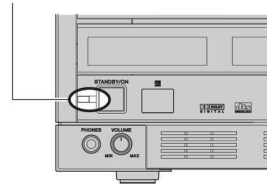

STEP 2 Turning the Unit On and Entering the Update Mode

- ① Set the Main Power switch on the rear panel to ON to put the unit in Standby mode.

* Verify that the Power indicator on the front panel lights up in orange.

- ② While holding the ENTER button on the front panel, press the STANDBY/ON button to turn the unit ON.

* Verify that the Power indicator on the front panel changes to green when the system starts up.

- ③ When the display panels shows "PLEASE WAIT", release the ENTER button.

* Hold the ENTER button until "PLEASE WAIT" appears on the display panel.

STANDBY/ON Button
Display Panels
ENTER Button

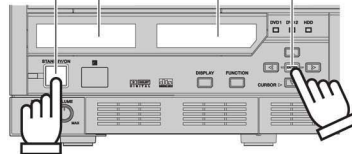

While holding ENTER button, press STANDBY/ON button.

The initial display indicates when the update disc should be inserted into Drive 1. Follow the on-screen instructions.

During startup, the display panel shows the messages "Power-ON" then "PLEASE WAIT".

When PGM-Install is displayed the disc tray opens. Place the update disc on the tray and proceed to step 3.

- PRV-LX1 Program Installer -

PLEASE INSERT INSTALLATION CD IN DRIVE ONE, THEN PRESS [ENTER] BUTTON ON FRONT PANEL FOR 2 SECONDS TO BEGIN UPDATE.

>>

Initial Display on Monitor Screen

STEP 3 Upgrading the System

- ① Press and hold the ENTER button on the front panel for 2 to 3 seconds.

The disc tray closes and the unit automatically starts to read the update program.

Hold down the ENTER button until the tray closes.

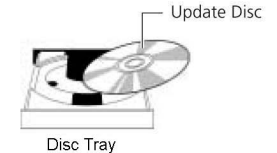

- ② When the display panel shows "DOWNLOAD FULL", updating of the system begins.

* During the update process, the monitor screen displays the messages shown on the right. (The lower two lines reflect the step being executed and the progress.)

The update process takes approximately 10 minutes. When the update is complete the display returns to the original Startup screen and the Update disc is automatically ejected.

After the disc ejects, the monitor message changes to "DOWNLOAD COMPLETED". The unit automatically turns OFF and enters the Standby mode.

* The automatic shut down takes a few seconds. Do not switch the power OFF during this period.

* The unit enters the Standby mode with the drive tray open.

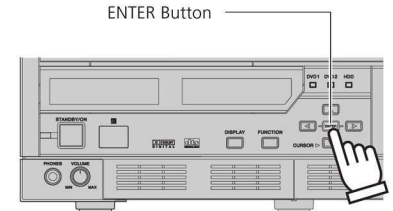

```
=====
= PRV-LX1 Program Installer =
=====
Setup Directories ...
Start Program Download ...
= Setup Drives. =
=====
```

Monitor Screen Display During Updating

- ③ Take out the update disc, restart the PRV-LX1 then close the disc tray manually.